

NE A/LAMPE/MINI/BK

## Mini Lampe De Marseille

by Le Corbusier

Mini version of the Lampe de Marseille designed by Le Corbusier for the Unite d'Habitation of Marseille in 1949/1952. Wall lamp is made from spun aluminium and available in Grey (RAL 7046), White Wash (RAL 9002), or Black Grey (RAL 7021) body with white internal diffusers. Direct and indirect lighting output with switch on the cable. Wall installation also without plug. Functional and adjustable wall light ideal for application in modern bedrooms.



|                 |                    |
|-----------------|--------------------|
| <b>Designer</b> | Le Corbusier       |
| <b>Supplier</b> | Nemo               |
| <b>Country</b>  | Italy              |
| <b>SKU</b>      | NE A/LAMPE/MINI/BK |
| <b>Finish</b>   | Black              |

Product Dimensions

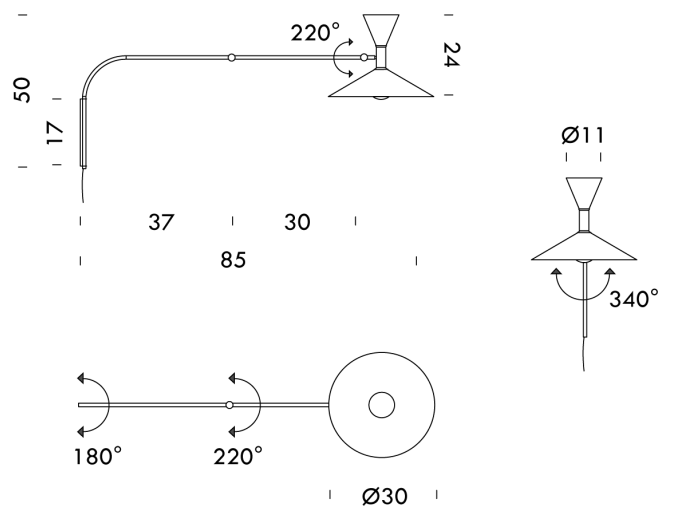

|                 |                           |                  |           |                |                             |
|-----------------|---------------------------|------------------|-----------|----------------|-----------------------------|
| <b>Weight</b>   | 1.3kg                     | <b>Materials</b> | Aluminium | <b>Source</b>  | 2 x E14 (42W Max Up & Down) |
| <b>Emission</b> | double, direct + indirect | <b>IP Rating</b> | IP20      | <b>Dimming</b> | No                          |